

## PRECAUTIONARY MEASURES REGARDING FIRE AND VENTILATION

- Additional ventilation will be necessary when using gas or other combustion devices.
- Do not place any hot devices close to the walls, roof or curtains.
- Always observe the safety instructions for these devices.
- Never allow children to play in the vicinity of hot devices.
- Keep exits free of obstructions.
- Make sure that you are well aware of the precautions against fire on the premises.
- Make sure that the ventilation openings are open at all times in order to prevent suffocation.

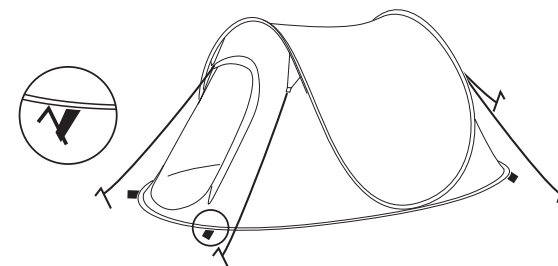

- Use steel tent pegs to attach the tent floor at the 5 attachment tabs.
- Properly tension the guy lines with the steel tent pegs.

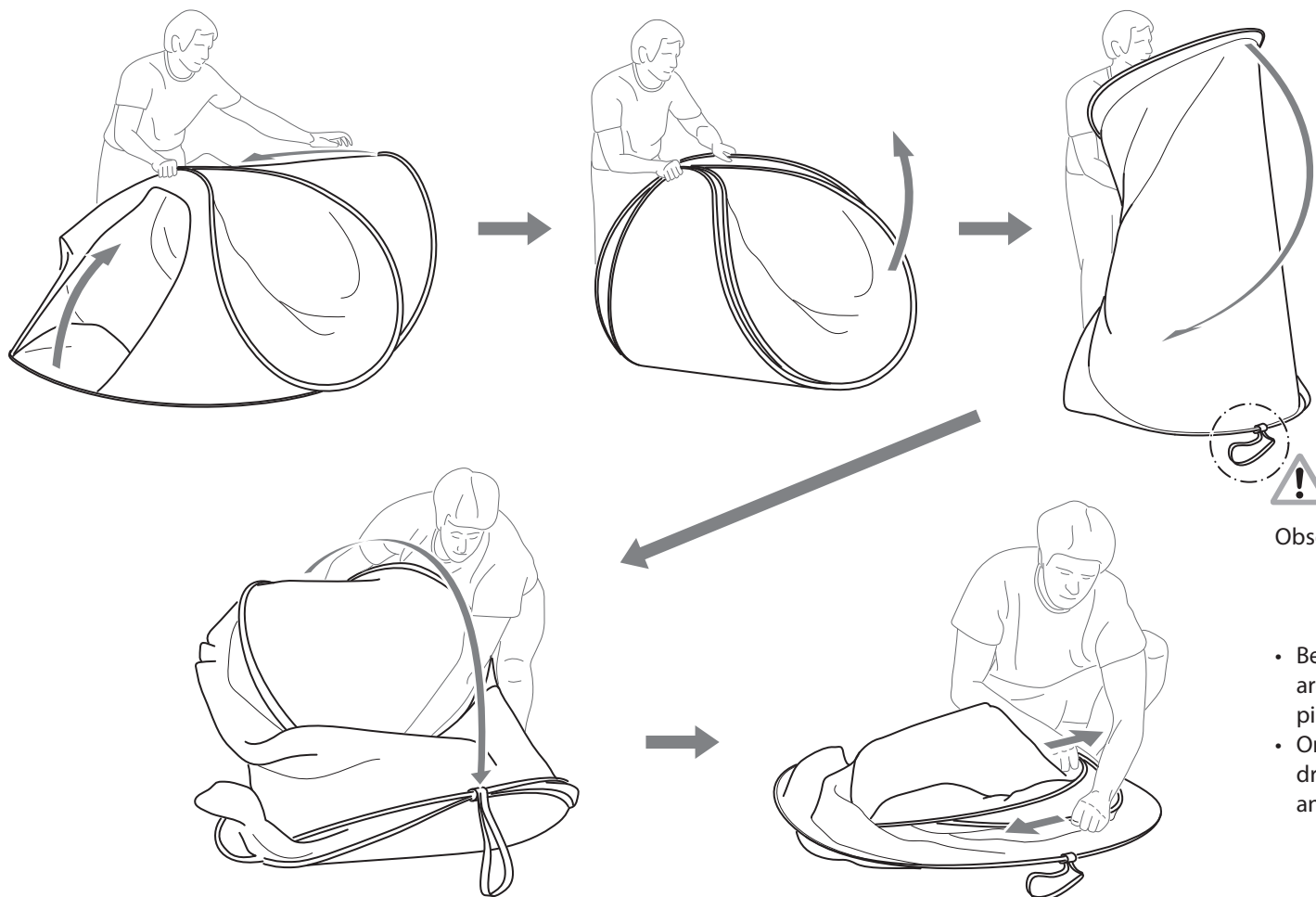

Observe the position of the tensioning strap!

- Before packing the tent, place the tensioning strap around the tent in order to prevent the tent from popping open.
- Only pack the pop-up festival tent when it's completely dry, in order to prevent mould stains, fabric damages and possible fabric discolorations.