

ALDI guarantees that our exclusive brand products are developed to our stringent quality specifications. If you are not entirely satisfied with this product, please return it to the nearest ALDI store within 60 days from the date of purchase, for a full refund or replacement, or take advantage of our after sales support by calling the supplier's Customer Service Hotline.



Made in China

AutoXS® is a registered trademark of ALDI Stores

DISTRIBUTED BY:

ALDI STORES

1 SARGENTS ROAD

MINCHINBURY NSW 2770

www.aldi.com.au

AFTER SALES SUPPORT

97361 



AU

1800 269 981



support@eurocentra.com.au

MODEL:

FLX-WH-01AUS

03/2019

3
YEAR
WARRANTY

User Manual



CAR JACK





Contents

Overview	4
Use	5
Package contents/parts	6
General information	7
Reading and storing the user manual	7
Explanation of symbols	7
Safety	8
Proper use	8
Safety instructions.....	8
First use	13
Checking the jack and package contents.....	13
General inspection	13
Jack assembly	14
Attaching the carrying handle	14
Assembling the lifting lever.....	14
Attaching the lifting lever	15
Using the jack	15
Preparing the vehicle	15
Positioning the jack.....	15
Lifting a vehicle.....	16
Lowering a vehicle	17
Troubleshooting	18
Maintenance, service and inspection	19
Refilling the oil	20
Changing the oil	21
Cleaning and storage	22
Technical data	23
Disposal	23
Disposing of the packaging	23
Disposing of the jack	23
Warranty Details	
Repair and Refurbished Goods or Parts Notice	

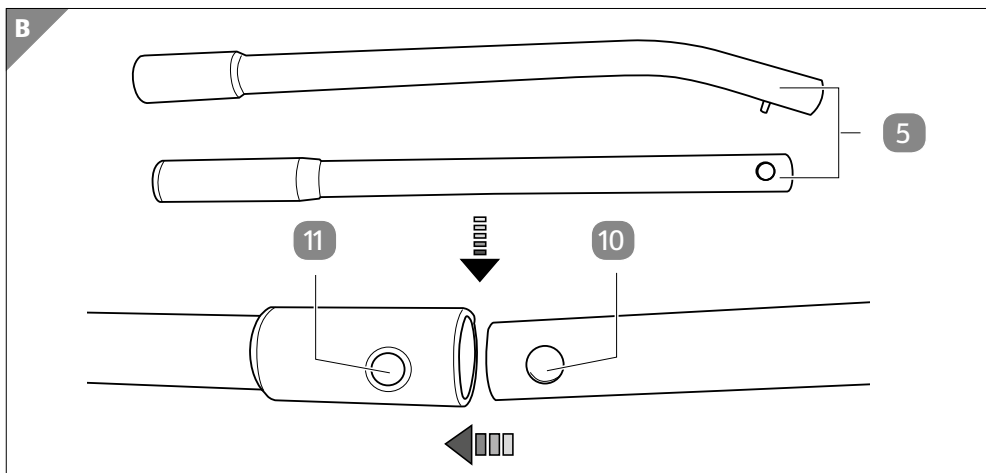
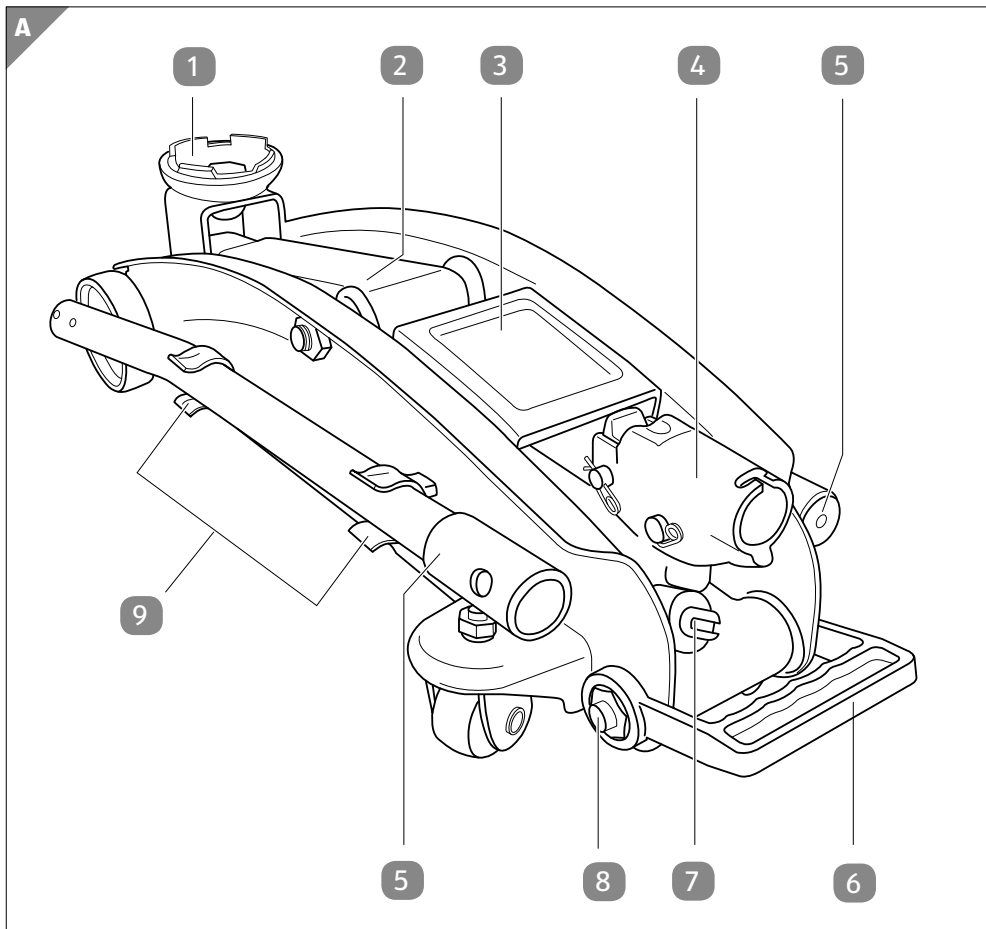

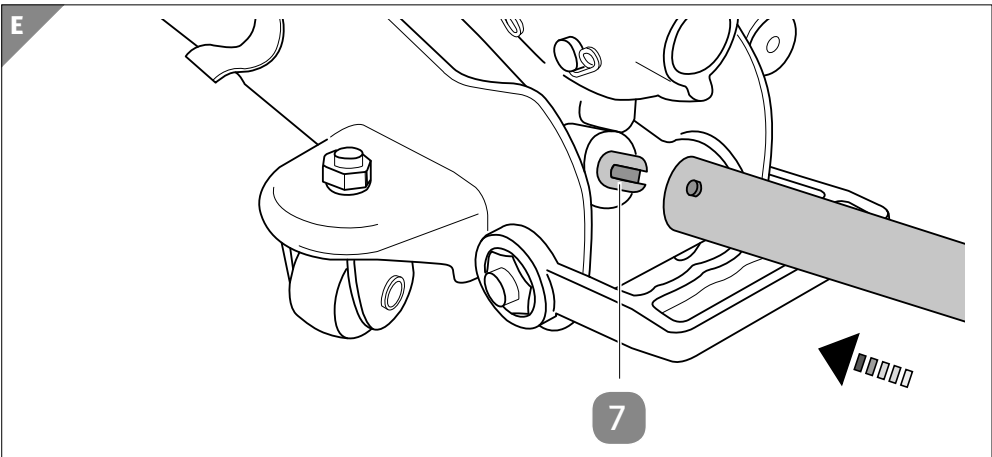
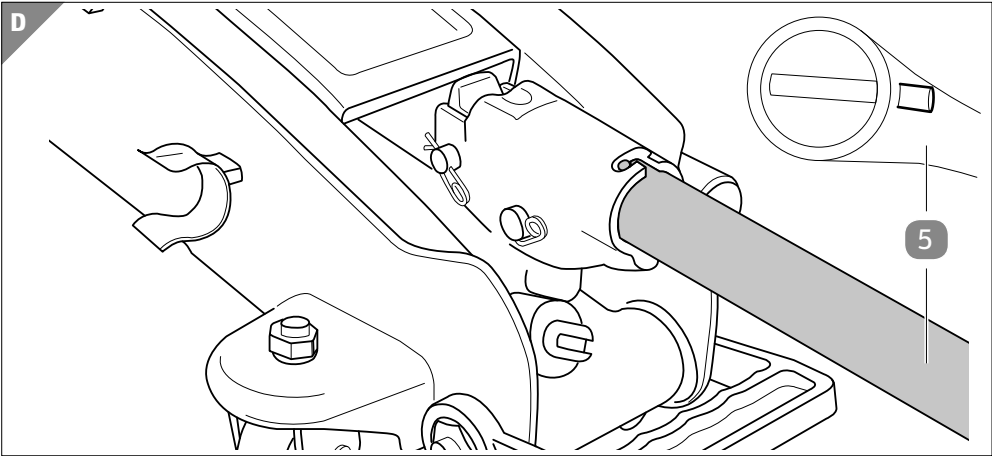
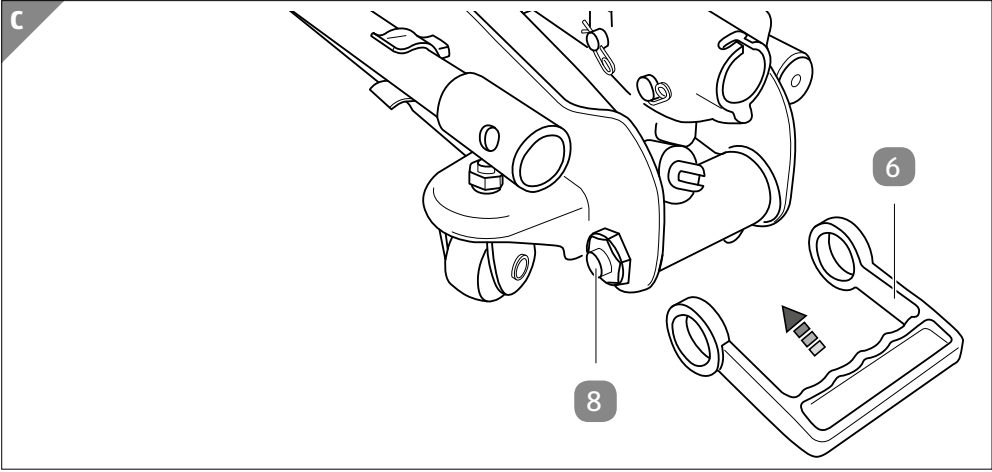

Package contents/parts

- 1 Saddle
 - 2 Lifting arm
 - 3 Cover plate
 - 4 Lifting lever socket
 - 5 Lifting lever
 - 6 Carrying handle
 - 7 Release screw
 - 8 Carrying handle nut
 - 9 Lifting lever clip, 4 x
 - 10 Locking pin
 - 11 Drilled hole
- User Manual / Warranty Card

General information

Reading and storing the user manual



This user manual accompanies this 2 ton car jack (hereafter referred to as the jack), and contains important information on setup and handling.

Before using the jack, read the user manual carefully. This particularly applies to the safety instructions. Failure to do so may result in personal injury or damage to the jack.

Store the user manual for further use. Make sure to include this user manual when passing the jack on to third parties.

Explanation of symbols

The following symbols and signal words are used in this user manual, on the jack or on the packaging.



This signal symbol/word designates a hazard with a high degree of risk, which will result in death or severe injury if not avoided.



This signal symbol/word designates a hazard with moderate risk, which may result in death or severe injury if not avoided.



This signal symbol/word designates a hazard with low risk, which may result in minor or moderate injury if not avoided.



This signal symbol/word warns of possible damage to property.



This symbol provides you with useful additional information on handling and use.



Death or injury from incorrect use.



Use two support stands.



Flat hard level ground.



Free to roll during lifting and lowering.

Safety

Proper use

The jack is exclusively designed for the short-term raising and lowering of vehicles not exceeding 2000 kg. It is only intended for private use and not suitable for commercial purposes.

Only use the jack as described in this user manual. Any other use is considered improper and may result in damage to property or persons.

The manufacturer or vendor cannot be held liable for damages or injury incurred through improper or incorrect use.

Safety instructions

DANGER! Risk of injury!

Never use the jack to lift up people or animals. Doing so may cause serious personal injury or even death.

- Only use the jack to raise or lower vehicles.

⚠ DANGER! Risk of injury!

During use, the jack and vehicle must be monitored at all times to avoid a hazard. Failure to do so may result in severe personal injury or even death.

- Pay attention to the stability of the jack and the vehicle. The jack must be placed on a hard, stable, level and wobble-free surface.
- Make sure that the jack is free to roll during lifting and lowering.
- Never lift a vehicle that weighs more than 2000 kg, even for a short period of time.
- Keep children and pets away from the vehicle when it is on the jack.
- Never lift a vehicle if it is occupied and keep all bystanders a safe distance away from the vehicle.
- Centrally locate the load on the head cap.
- Support the vehicle on suitably-rated vehicle support stands and remove the jack prior to starting work on the vehicle.
- No one should be physically under a vehicle when it is supported only by the jack.

⚠ WARNING! Risk of injury!

The operator of the jack must have an understanding of the jack and safe operating procedures before attempting to use it. Failure to do so may result in personal injury.

- Consult the vehicle's user manual prior to lifting the vehicle.
- Always be sure to wear the appropriate personal protective equipment when using the jack.
- Inspect the jack before each use. Do not use the jack if there are any loose parts or visible damage. If this is the case, do not

use the jack and have it inspected by a qualified professional. Conduct a pre-operational check of the equipment.

- Only use the jack for lifting and lowering vehicles; the raised vehicle should be supported on suitably-rated vehicle support stands. Using the jack as a vehicle support stand can damage it and may lead to personal injury.
- Do not move or dolly the vehicle while on the jack. The jack cannot withstand these stresses and may lead to personal injury and/or property damage.
- Modifications must not be carried out or accessories added. Do not open the housing. There are no user-repairable or user-replaceable parts on the jack. Liability and warranty claims are waived in the event of repairs performed by the user, incorrect use, or incorrect operation. If repairs are needed, contact the manufacturer via the service address on the warranty card.
- Only parts that comply with the original jack may be used for repairs. The jack contains mechanical parts which are essential for providing protection against sources of danger.
- Do not tamper with the jack in any way and do not use any accessories.
- Only carry the jack using the provided carrying handle, ensuring that it is securely attached to the jack.
- Only use the jack in dry weather or dry environments.
- Do not use the jack in damp indoor areas or in the rain.
- Never store the jack where it is in danger of falling.
- Never insert any objects into the housing.
- Do not exceed the rated capacity of the jack.
- Only use the jack on hard, level surfaces. Do not put the jack on a weak surface (e.g. grass). Weak surfaces may cause the

vehicle to wobble and fall off the jack, resulting in damage and/or personal injury.

- Keep clear of the vehicle while lifting and lowering it.
- Always slowly lower the vehicle.
- Apply the parking break and chock the unlifted wheels before lifting a vehicle.
- Only lift the vehicle at manufacturer recommended locations.
- The jack is designed to be used with a head cap that is 60 mm in diameter and a lifting lever that is 695 mm long.
- Before each use, always check that the labels and nameplates are clear and legible, as these carry important information. If they are missing or unreadable, contact the manufacturer via the service address on the warranty card.



Danger for children and persons with impaired physical, sensory or mental capacities (e.g., partially disabled persons, older persons with reduced physical and mental capacities) or lack of experience and knowledge (e.g. older children).

- The jack may not be used by persons with impaired physical, sensory or mental capacities or those lacking experience and knowledge. Children may not use jack. Cleaning and user maintenance must not be performed by children.
- Do not leave the jack unattended while in use.
- Keep children away from the jack.
- Do not let children play with the jack.
- Keep persons with impaired sensory or mental capacities away from the jack.

- Make sure that children do not play with the plastic wrapping. They may get caught in it when playing and suffocate.

▲ WARNING! Risk of injury!

Using the jack in extreme or adverse conditions, and environments may result in personal injury.

- Do not use the jack in extreme or adverse weather conditions (e.g. extremely cold or hot climates, or in strong winds, and strong magnetic fields) as the jack may not function properly and may cause injury. The vehicle may become unstable.
- Do not use the jack in potentially explosive environments, near explosives, or in mines. The oil in the pump cylinder is flammable.
- Do not use the jack while on a ship. The vehicle will become unstable.

NOTICE! Risk of damage!

Improper handling of the jack may result in damage to the jack.

- Always place the jack securely (please refer to your vehicle's user manual for the correct position). The surface should be hard (e.g. concrete), stable, level and even, and should be able to handle pressure of up to 2.2 short tons.
- Never immerse the jack in water for cleaning, this may damage the jack. Follow the instructions in the chapter "Cleaning and storage."
- Do not use the jack if the housing is cracked, deformed, or broken (see the chapter "Maintenance, service, and inspection"). Stop using it immediately and contact the manufacturer via the service address indicated on the warranty card.

First use

Checking the jack and package contents

NOTICE! Risk of damage!

If you are not cautious when opening the packaging with a sharp knife or another pointed object, you may quickly damage the jack.

- For this reason, be very careful when opening it.
- 1. Check to make sure that all components and accessories have been received (see **Fig. A**).
- 2. Take the jack out of the packaging and check whether it or any of the individual parts are damaged. If this is the case, do not use the jack. Contact the manufacturer via the service address indicated on the warranty card.



The jack does not require first-time lubrication. The oil is self-contained and can be checked regularly.

⚠ WARNING! Risk of injury!

The jack contains small parts that can cause choking if swallowed.

- Keep all small parts away from children and pets.

General inspection

- Before each use check that the release screw **7** on the jack is completely closed (turned fully clockwise), and check that there is enough oil inside the oil cylinder **13** (see chapter “Maintenance, service, and inspection”).
- Before and after each use, pump the lifting lever **5** a few times to ensure that the oil is distributed evenly.

Jack assembly

Attaching the carrying handle

On each side of the lifting lever socket (4) is a nut to which the carrying handle (6) needs to be attached.

1. Place one of the carrying handle's "eyes" over the carrying handle nut (8) (see **Fig. C**).
2. Carefully stretch and fit the carrying handle's other eye into place. You may need to exert a bit of pressure on the carrying handle's eyes to push them properly into place. The carrying handle should now sit snugly in place (see **Fig. A**).
3. Before carrying the jack, make sure the carrying handle fits snugly in place by pushing the jack back and forth. The carrying handle should stay securely attached during this. If it is not, re-attach the carrying handle.

Assembling the lifting lever

1. Align the 2 halves of the lifting lever (5) with the locking pin (10) in one section with the drilled hole (11) in the other section (see **Fig. B**).
2. Push both pieces together until the locking pin "clicks" (see **Fig. B**).

 To disassemble the lifting lever, remove the lifting handle from the jack. Push down on the locking pin to separate the two halves, then snap each half into place in the lifting lever clips (9) on either side of the jack (see **Fig. A** and **B**).

Attaching the lifting lever

1. Take the assembled lifting lever **5** and align the notched end with the lifting lever socket **4** on the jack (see **Fig. D**).
2. Push the lifting lever into the lifting lever socket and turn it to engage the bayonet lock (see **Fig. D**). Make sure it is firmly attached.

Using the jack

⚠ DANGER! Risk of injury!

If the jack is not placed correctly, the vehicle may not rise evenly and can suddenly fall. This may result in severe injury or death.

- Read the vehicle's user manual regarding proper use and placement of the jack.

Preparing the vehicle

1. Before using the jack, make sure that the vehicle's emergency brake has been fully and securely engaged.
2. If the vehicle uses automatic transmission, put the transmission into the "Park" position.
3. For manual transmissions, put the vehicle into 1st gear.
4. Chock the wheels securely (chocks not included).

Positioning the jack

1. Make sure that the lifting arm **2** is fully lowered.
2. Make sure that the release screw **7** is closed by using the bar at the end of the lifting lever **5** to turn it fully clockwise (see **Fig. E**).

3. Carefully position the saddle **1** of the jack under the vehicle manufacturer's recommended lifting point.
4. Pump the lifting lever until the top of the jack's saddle has nearly reached the vehicle lifting point.

Lifting a vehicle

DANGER! Risk of injury!

Never work on, under, or around a vehicle that is supported only by a jack. The vehicle may not be stable and may suddenly fall, resulting in personal injury or even death.

- Always use jack stands (not included) immediately after using the jack to lift a vehicle. Do not rely on the jack to support the vehicle.
1. Once the jack has been properly placed at the vehicle's lifting point, pump the lifting lever **5** using smooth, full strokes.
 2. Lift the vehicle a few inches above the desired height.
 3. Once the vehicle is raised, slide a jack stand of appropriate capacity (not included) under the proper lifting point referred to in the vehicle's user manual. If using two jack stands, position them at the same point and height on each side of the vehicle.
 4. Center the vehicle's lifting point(s) on the saddle of the jack stand(s). Set the jack stand(s) according to the manufacturer's instructions, making sure that they lock securely into position.
 5. Slowly turn the release screw **7** counterclockwise using the bar at the end of the lifting lever to lower the vehicle onto the saddle(s) of the jack stand(s). Then, turn the release screw firmly clockwise to close it (see **Fig. E**).

6. Ensure that the load and jack stands are stable and secure. There should be no rocking or other movement, no matter how slight. If in doubt, use the jack to lift the vehicle again, then reposition and re-secure the vehicle on the jack stands.

Lowering a vehicle

DANGER! Risk of injury!

If there are people, animals, or objects in or under the vehicle before you lower it, this can cause personal injury, even death.

- Always ensure that the area under the vehicle is clear of people, animals and objects before lowering the vehicle.
 - Always use the jack to lower the vehicle.
1. Position the saddle **1** under the lifting point.
 2. Use the bar at the end of the lifting lever **5** to turn the release screw **7** firmly clockwise (see **Fig. E**).
 3. Pump the lifting lever to raise the vehicle slightly above the saddle(s) of the jack stands (not included).
 4. Remove the jack stands.
 5. Very slowly turn the release screw counterclockwise to lower the vehicle onto the ground.
 6. Remove the jack and allow the lifting arm **2** to lower fully.
 7. Close the release screw by turning it clockwise.

Troubleshooting

Problem	Possible causes	Solution
Jack doesn't lift the vehicle.	- Not enough oil.	- Refill oil (see chapter "Maintenance, service, and inspection").
	- Dirty oil is blocking the release valve.	- Change the oil (see chapter "Maintenance, service, and inspection").
	- Release screw 7 is not fully closed.	- Fully close the release screw.
Jack doesn't lower the vehicle.	- Release screw is not fully open.	- Fully open the release screw.
	- Too much oil is in the oil cylinder.	- Let some oil out of the oil cylinder (see chapter "Maintenance, service, and inspection").
	- Dirty oil is blocking the release valve.	- Change the oil (see chapter "Maintenance, service, and inspection").
Visible damages.	- Cracked or bent parts from falling or other impacts.	- Have the jack inspected and/or repaired by qualified personnel.
Jack is leaking oil.	- The cylinder or seals may be broken.	- Contact the manufacturer via the service address on the warranty card.
The jack makes noises when lifting or lowering a vehicle.	- Moving parts of the jack are not fully lubricated.	- Lubricate the affected parts with some oil.
	- The cylinder is broken.	- Contact the manufacturer via the service address on the warranty card.

Maintenance, service, and inspection

CAUTION! Risk of damage and injury!

A working area contaminated with oil can cause the jack to slip and result in damage and/or personal injury.

- Thoroughly clean the area where the work will take place before raising or lowering vehicles in this area.



- Lubricate all moving parts at regular intervals.
- The oil in the oil cylinder should be changed every 3 years.

- Always check the jack before each use.
- Check for cracks, cracked welds and missing and/or loose and/or damaged parts. If the jack appears to be damaged or deformed in any way, do not use the jack.
- If you believe that the jack has been subjected to an abnormal load or shock, the jack must be inspected immediately by the manufacturer.
Contact the manufacturer via the service address indicated on the warranty card.
- If the jack has any problems or missing parts, is damaged, deformed, or cracked, contact the manufacturer via the service address indicated on the warranty card.

Refilling the oil

⚠ DANGER! Risk of injury!

Filling the oil cylinder with too much oil can cause the jack to become overloaded, resulting in injury.

- Only fill the oil cylinder with the amount recommended in this chapter.

NOTICE! Risk of damage!

Using the wrong oil may damage the jack or cause it to malfunction.

- Only use the type of oil as given in the chapter “Technical data.”

1. Fully lower the jack, make sure the release screw **7** turned fully clockwise, and lift up the cover plate **3**.
2. Carefully lift up and remove the rubber seal **12** of the oil cylinder **13** up with a flat-head screwdriver.

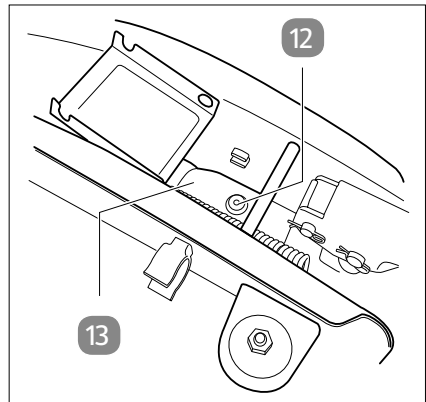

3. Fill the oil until the piston rod of the cylinder is barely covered. Make sure that no oil is spilled. If necessary, use a small funnel to fill the oil.
4. Clean the rubber seal and insert it back into the oil cylinder, making sure to press it firmly back into place.
5. Lower the cover plate.

Changing the oil



- Check the condition of the oil at least once a year; if there are impurities or foreign substances, change the oil.
- If the jack is used on a very regular basis, check the condition of the oil at regular intervals.

1. With the jack fully lowered and the release screw **7** turned fully clockwise, lift up the cover plate **3**.
2. Carefully lift up and remove the rubber seal **12** of the oil cylinder **13** up with a flat-head screwdriver.
3. Tip the jack to allow the old oil to drain out of the oil cylinder and dispose of it in accordance with local regulations.
4. Clean any spilled oil off of the jack.
5. With the jack completely upright, fill the oil cylinder with the recommended oil (see chapter “Technical data”) until the piston rod of the cylinder is barely covered.
6. Clean the rubber seal and insert it back into the cylinder, making sure to press it firmly back into place.

Cleaning and storage

NOTICE! Risk due to improper operation!

Improper handling of the jack may result in damage.

- Do not use any aggressive cleaners, brushes with metal or nylon bristles, or sharp or metallic cleaning utensils such as knives, hard scrapers and the like. They could damage the surfaces.
- Always store the jack safely. Never store the jack in such a way that it may fall.
- Avoid direct contact of foodstuffs with the product.
- Clean the jack with a lightly oiled cloth.
- Always ensure that the lifting arm **2** is fully lowered and that the lifting lever **5** is securely attached to the jack via the lifting lever clips **9** (see **Fig. A**).
- Store the jack in a cool, dry place away from direct sunlight, extreme temperatures (heat and cold), weather effects (e.g. rain), and chemicals and aggressive vapors.
- Store the jack in a secure place that is not accessible to children or animals.

Technical data

Model:	FLX-WH-01AUS
Head cap height:	17 mm
Maximal height of the head cap	
- with load:	325 mm
- without load:	330 mm
Weight:	9.57 kg
Dimensions (L × W × H):	483 × 189 × 135 mm
Oil type:	SAE-10

As our products undergo continual development and improvement, technical changes and changes to the product design are possible. This user manual can be downloaded as a PDF file from our homepage **www.flexxtrade.de**

Disposal

Disposing of the packaging

- Sort the packaging before you dispose of it. Dispose of paperboard and cardboard with the recycled paper service and wrappings with the appropriate collection service.

Disposing of the jack

- Should the jack no longer be capable of being used at some point in time, separate the oil from the jack and **dispose of both of them in accordance with the regulations in force in your city or state.**



Car jack



Warranty Details

REGISTER YOUR PURCHASE AT www.aldi.com.au/en/about-aldi/product-registration/ TO KEEP UP-TO-DATE WITH IMPORTANT PRODUCT INFORMATION

The product is guaranteed to be free from defects in workmanship and parts for a period of 36 months from the date of purchase. Defects that occur within this warranty period, under normal use and care, will be repaired, replaced or refunded at our discretion. The benefits conferred by this warranty are in addition to all rights and remedies in respect of the product that the consumer has under the Competition and Consumer Act 2010 and similar state and territory laws.

Our goods come with guarantees that cannot be excluded under the Australian Consumer Law. You are entitled to a replacement or refund for a major failure and for compensation for any other reasonably foreseeable loss or damage. You are also entitled to have the goods repaired or replaced if the goods fail to be of acceptable quality and the failure does not amount to a major failure.

AFTER SALES SUPPORT

  1800 269 981
Toll-free hotline

 support@eurocentra.com.au
MODEL: FLX-WH-01AUS PRODUCT CODE: 94361 03/2019





Car jack

Repair and Refurbished Goods or Parts Notice

REGISTER YOUR PURCHASE AT www.aldi.com.au/en/about-aldi/product-registration/ TO KEEP UP-TO-DATE WITH IMPORTANT PRODUCT INFORMATION

Unfortunately, from time to time, faulty products are manufactured which need to be returned to the Supplier for repair.

Please be aware that if your product is capable of retaining user-generated data (such as files stored on a computer hard drive, telephone numbers stored on a mobile telephone, songs stored on a portable media player, games saved on a games console or files stored on a USB memory stick) during the process of repair, some or all of your stored data may be lost.

We recommend you save this data elsewhere prior to sending the product for repair.

You should also be aware that rather than repairing goods, we may replace them with refurbished goods of the same type or use refurbished parts in the repair process.

Please be assured though, refurbished parts or replacements are only used where they meet ALDI's stringent quality specifications.

If at any time you feel your repair is being handled unsatisfactorily, you may escalate your complaint. Please telephone us on 1800 269 981 or write to us at:

Euro Centra (Australia) Pty Ltd
c/o Install and Fix Solutions Pty Ltd Unit 4
26 Navigator Place Hendra, Qld 4011

AUSTRALIA

1800 269 981 (8.30 am – 6.00 pm Monday – Friday)

support@eurocentra.com.au

AFTER SALES SUPPORT

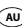
  1800 269 981
Toll-free hotline

 support@eurocentra.com.au
MODEL: FLX-WH-01AUS PRODUCT CODE: 94361
03/2019

